

Cassette Blinds



C40 Sidewinder

Features:

All of the C40 sidewinder cassetted blinds come with an enclosed aluminium head-box and side channels as standard. The cassette is designed for top or face fixing and accommodates 32, 45, 53 or 70mm grooved aluminium barrels, depending on blind size and fabric weight. Fabric is locked into groove in barrel, and features aluminium bottom bar with pile seal. A robust Slipstream® sidewinder mechanism provides the effective means of operation with the use of metal control chain, held in place by a chain tidy. Studs fitted at edge of fabric to retain it within side channels. Black or white hardware as standard.

Benefits:

The excellent performance of a cassetted blind is further enhanced by the addition of side channels, giving positive and consistent location of the fabric and bottom bar, and provides light exclusion if blackout fabric is used. The entire range is offered as an aesthetically pleasing solution, protecting the fabric in the process. The quality sidewinder mechanisms are simple to operate and allow accurate control of blind position.

Options:

Black or white hardware; Without side channels, C20-60/90/120; Tracker fabric retaining system; Available in any RAL colour.

Specification:

C40-60/90/120 cassetted blind with side channels. Flame retardant fabric from the range, locked into grooved 32/45/53/70mm aluminium barrel along with aluminium bottom bar as standard. Black/white aluminium cassette, side channels and bottom bar and incorporating metal control chain.

Please refer to NBS Plus N10 240.

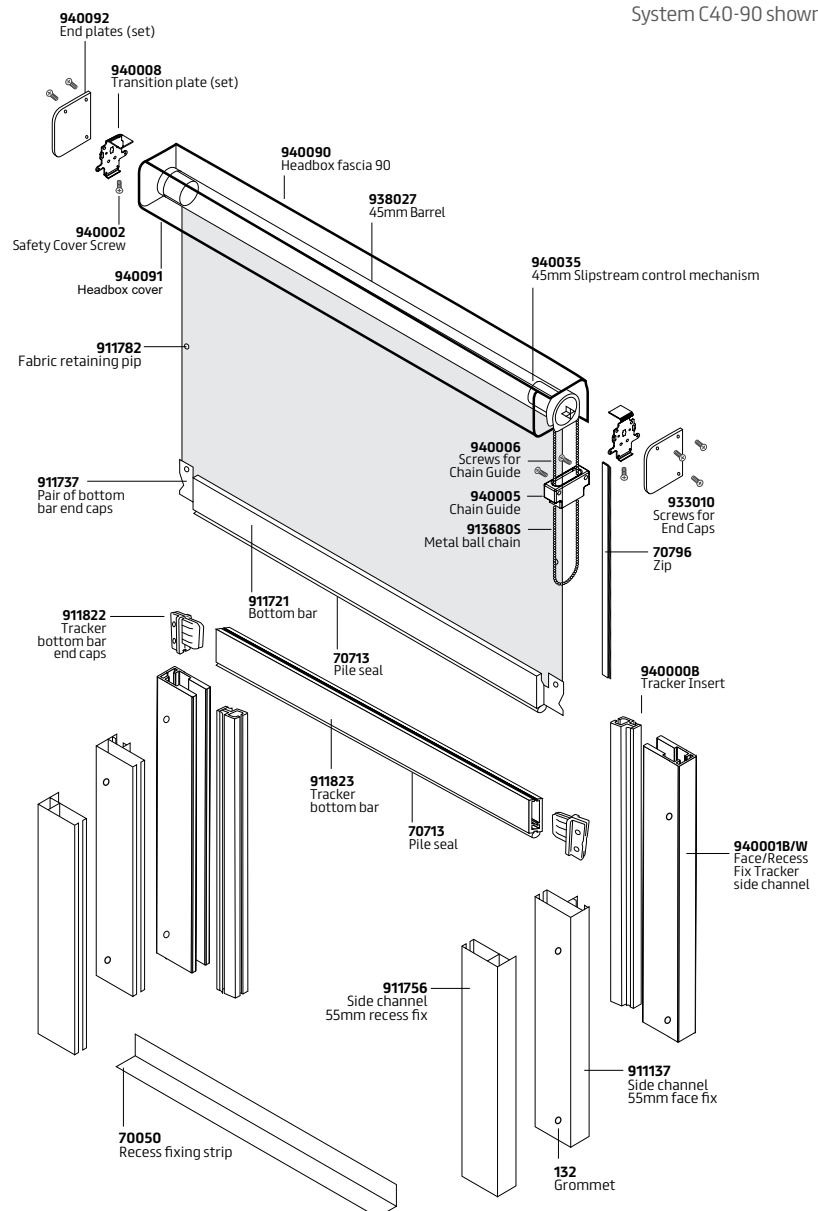

System C40-90 shown.

Cassette Blind Profile Dimension Guide

Model	Cassette Size (HxD)	Barrel Size Ø	Side Channel Size (WxD)
C40-60	77 x 73mm	32mm	55 x 13mm
C40-90	105 x 95mm	45mm	55 x 13mm
C40-120	140 x 120mm	53 / 70mm	55 x 13mm